

Versatile roof technology for many applications in lightweight design

Production certificated according to
DIN ISO 9001/EN 29 001
by TÜV-CERT



Lightweight cassette roof system

Versatile. Lightweight. System-independent.

Layher® 

More Possibilities. The Scaffolding System.

More possibilities. With innovative technology.

Layher lightweight cassette roof system

V e r s a t i l e . L i g h t w e i g h t . S y s t e m – i n d e p e n d e n t .

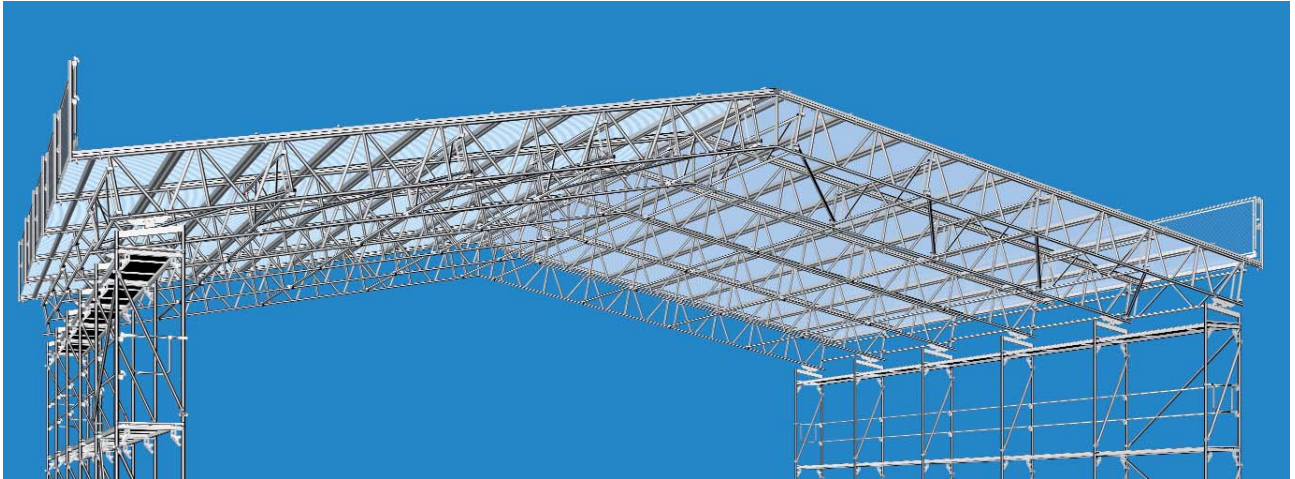

The lightweight cassette roof (LWCR) is a very light roof with a roof covering of aluminium/PVC roof cassettes that can be erected on non-system lattice girders. With a few extra parts, sturdy yet lightweight roofing can be provided for a wide range of applications.

Depending on the lifting equipment available and on the span selected, the roof can be constructed in two methods.

- 1 Erection by crane
- 2 Erection by hand

Both variants are described in detail in the instructions for assembly and use of the roof.



Additional parts for LWCR

without bracing and without safety equipment

U-Profile, Aluminium
for fastening on the top chord of the lattice girder

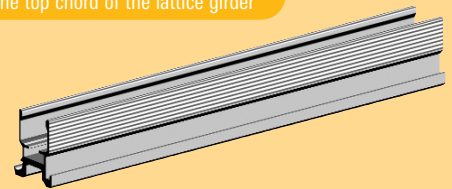

Shell clamp
for fastening of U-Profiles



Lightweight cassette
(aluminium frame with PVC covering)

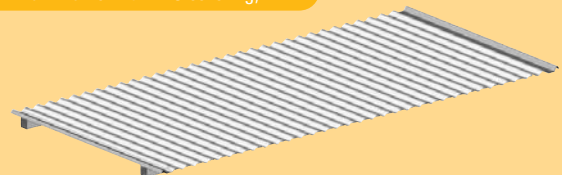

Rapid clamp
for fastening of cassettes



More possibilities. With well thought-out solutions.

The advantages of the LWCR

V e r s a t i l e . L i g h t w e i g h t . S y s t e m - i n d e p e n d e n t .



YOUR ADVANTAGES AT A GLANCE

Simple mounting with a few additional parts on non-system Layher lattice girders makes the lightweight cassette roof an economical roof solution for every scaffolding system. What's more, its aesthetic appearance makes it particularly suitable for use in city centre areas. And you always enjoy flexibility: removing individual cassettes is no problem in the lightweight cassette roof.

... simply looks good

- ▶ thanks to its aesthetic appearance it integrates excellently into the overall city surroundings and is hence ideal for work within city centres
- ▶ not only lightweight, but also stable: low-inflammability, hailproof, impervious to many chemical substances, UV and light-resistant, and safe against falling through
- ▶ translucent cassettes. As a result, additional light cassettes are not needed, besides there is no glare effect from sunlight affecting the work in progress under the roof

... pays for itself quickly

- ▶ can be fitted without problem onto all 750 lattice girders and hence can be easily used with every existing scaffolding system
- ▶ rapid assembly of the bracing elements using the proven Layher snap-on claws
- ▶ thanks to multiple use of the additional parts, e.g. of the U-profile and shell clamps for building birdcage scaffolding on non-system lattice girders, rapid amortization of the overall investment is assured

... makes light work

- ▶ the entire roof is extraordinarily light, with around 13.0 kg per m² (including lattice girders and bracing elements)
- ▶ the corners of the cassettes are protected from damage by the hook-in aluminium profile
- ▶ the lightweight cassettes can be stacked very easily with or without pallets

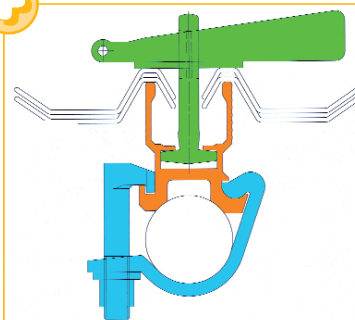

ADVANTAGE

The patented ingenious design permits stable and easy construction of this sturdy roof system on non-system lattice girders.



ADVANTAGE

The roof can be opened for supplying materials by removing individual lightweight cassettes. For roof access, lightweight cassettes with hatch are available.



ADVANTAGE

Versatile – not only in erection, but in storage too the lightweight cassette roof uses optimum components.

Layher® 
More Possibilities. The Scaffolding System.

Wilhelm Layher GmbH & Co. KG
Scaffolding Grandstands Ladders
Post Box 40
D-74361 Gueglingen-Eibensbach
Telefon +49 7135-70-0
Telefax +49 7135-70-265
E-Mail info@layher.com
www.layher.com